

ENFRANCHISEMENT MANOR COURT BOOKS OF CHELTENHAM 1854-1935

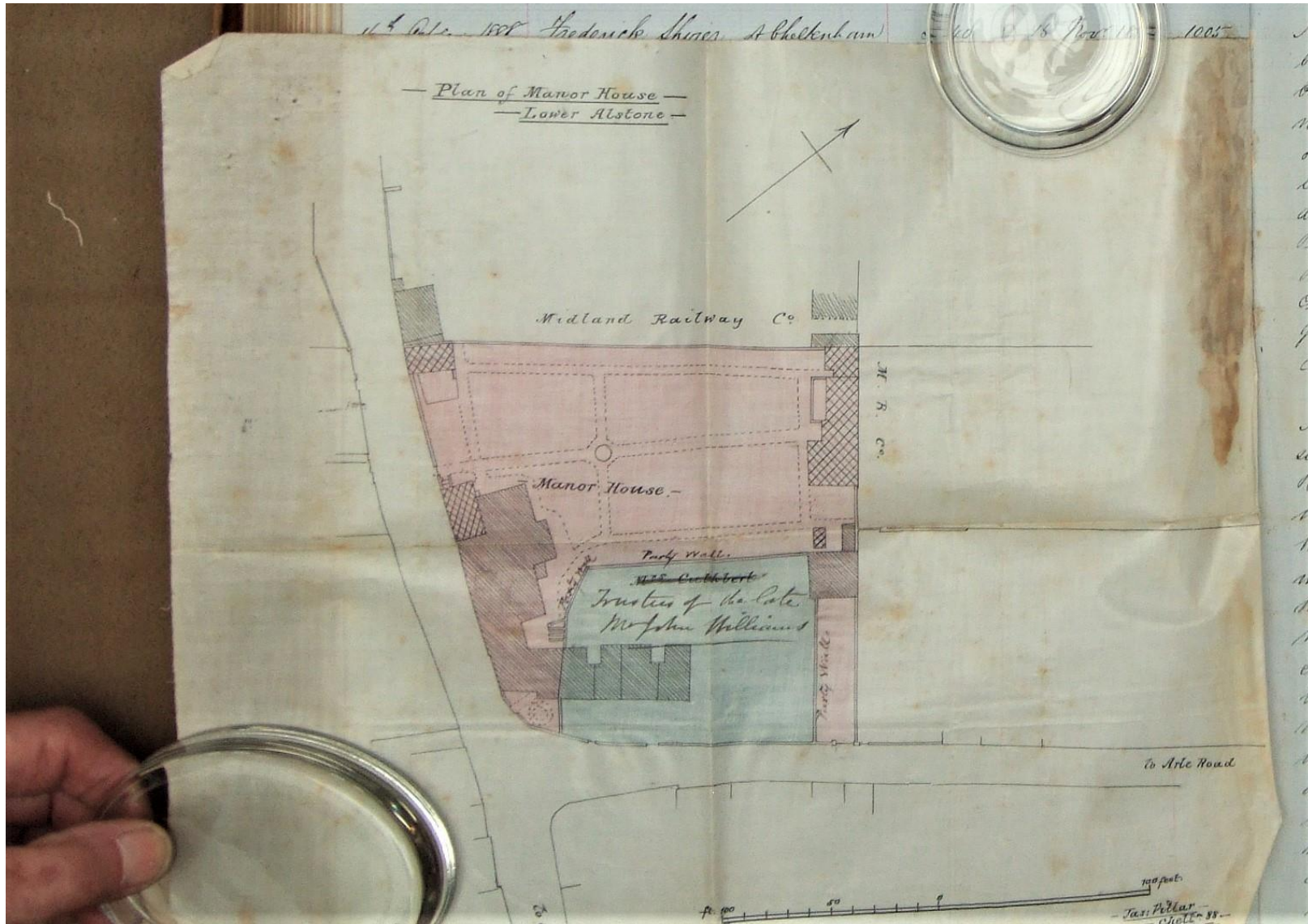

Gloucestershire Archives D2025/Box 35472 page 228c image DCSF0032

ENFRANCHISEMENT MANOR COURT BOOKS OF CHELTENHAM 1854-1935

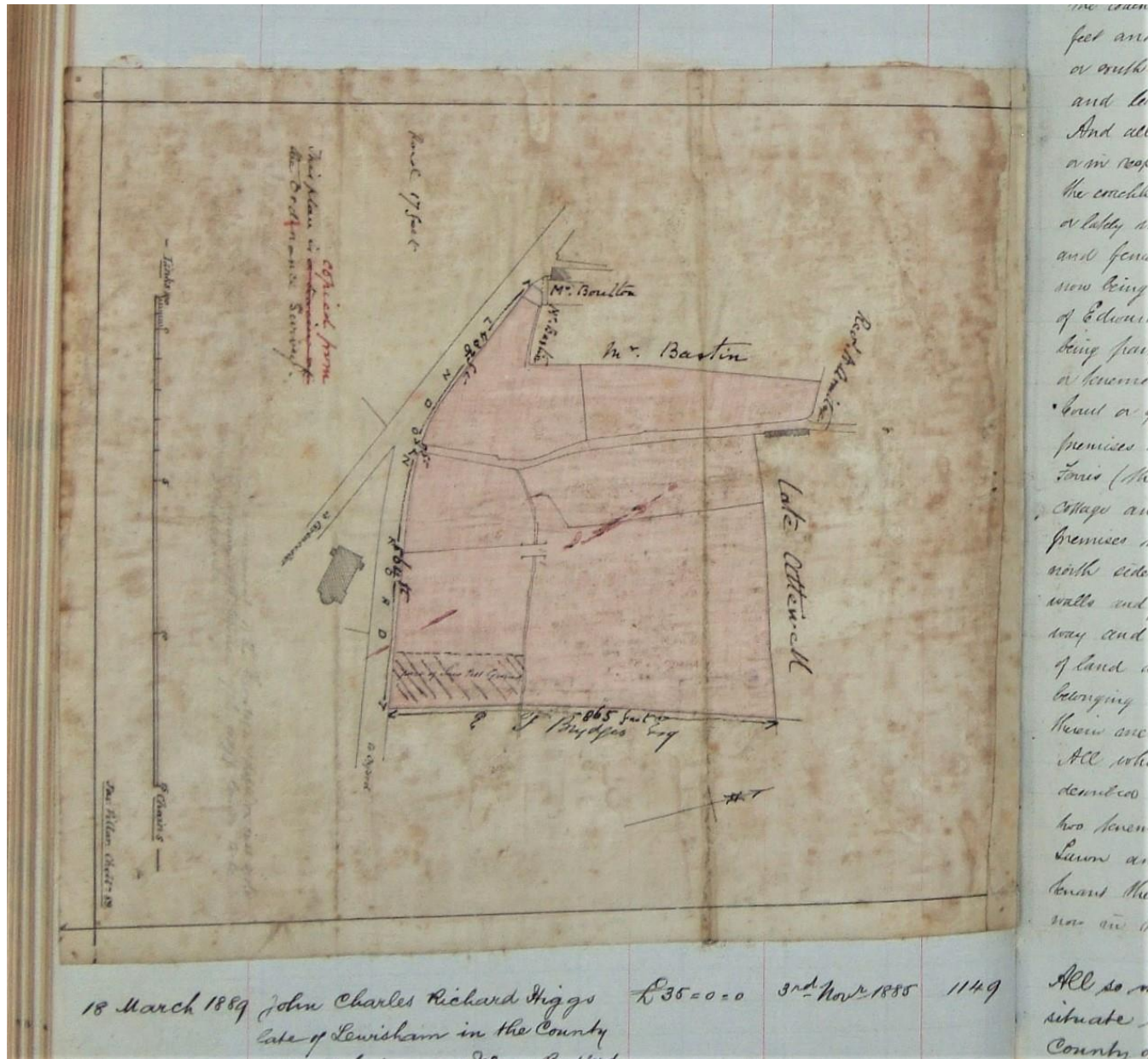

feet and
 or rush
 and low
 And all
 or in reape
 the conceale
 or laby an
 and fence
 now being
 of Edward
 being party
 or knowmen
 •Said or y
 premises
 Louis (the
 Village and
 premises n
 north side
 walls and
 way and
 of land a
 belonging
 Newin area
 All wher
 demises
 has bene
 Lams an
 toward the
 now an d
 All so m
 situate
 County of

Gloucestershire Archives D2025/Box 35472 page 237b image DCSF0041

ENFRANCHISEMENT MANOR COURT BOOKS OF CHELTENHAM 1854-1935

